

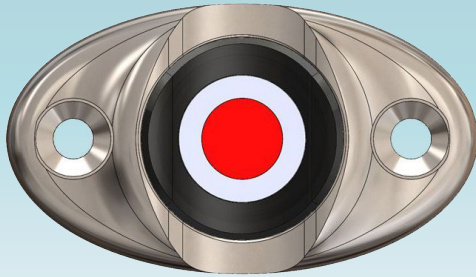

SURFACE MOUNT LED SIDE NAVIGATION LIGHT SET



The newest addition to our LED selection is our Surface Mount LED Navigation Light Set - a pair of low-profile lights mounted in a heavy-gauge stainless-steel cover designed to fit on flat surfaces and ideal for up to 40-foot boats.

FEATURES & BENEFITS

- Ideal for boats up to 40-feet long
- Provides reliable, long-lasting LED lighting for thousands of hours of maintenance-free use
- 3-watt white LED with a low draw of only .6 amps that compares to 10-watt incandescent light
- Easy installation with marine adhesive sealants
- Designed to fit small transom areas
- Meets ABYC-USCG requirements for both sail and powerboat designation 2nm
- Low-voltage 12 to 24VDC
- Anodized cylindrical aluminum heat sink for maximum heat dissipation
- LED light is mounted in a heavy-gauge, polished stainless-steel cover for a clean and unobtrusive look
- Water-resistant IP68 rating

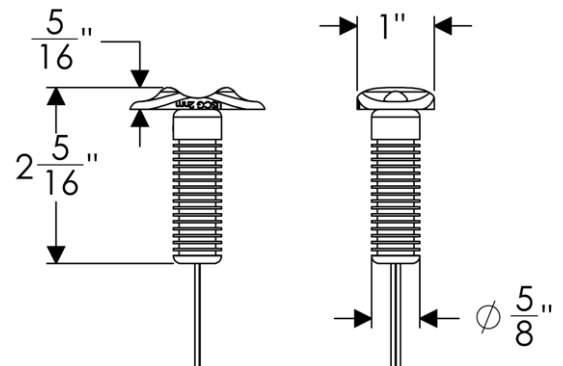
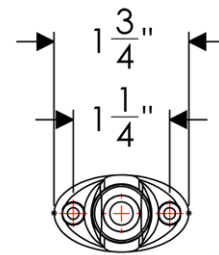
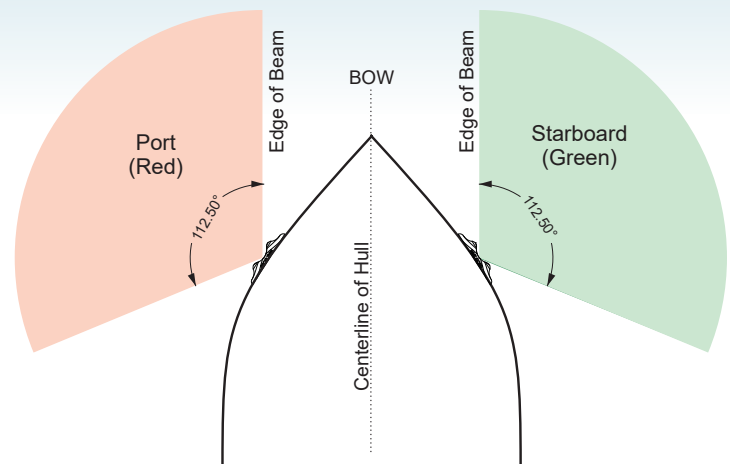

KIT INCLUDES

- Set of two LED navigation light assemblies, Port (Red) and Starboard (Green)
- Detailed installation/service instructions

Proper installation of Navigation Lights is very important.

Please contact TACO Marine customer service before purchasing or installing.

w tacomarine.com | ph 800.653.8568 | e info@tacomarine.com



PART NUMBER	DESCRIPTION	WIDTH	DEPTH	AMP DRAW	UNIT	PACK	UPC
F38-6610D	Surface Mount LED Side Navigation Light Set 1-3/4"	1"	1-3/4"	3/8"	0.6 amps @ 12V	Pair	12 630971089676